

TIVOLI Theatre

19-27 West Borough, Wimborne, Dorset BH21 1LT

Tel:01202 849103 Fax:01202 849483

Friends of the Tivoli A company limited by guarantee registered in Wales No 3001139

Registered Office 19-23 West Borough, Wimborne, Dorset BH21 1LT

Registered Charity No. 1053930

Tivimanco Ltd., a wholly owned subsidiary of Friends of the Tivoli Theatre

Company registered in Wales no. 3237197

VAT reg No. 679 6756 55

Stage information pack

Stage Dimensions:

Pros arch opening:	9.40M (30'8")
Height of pros:	6.40M (20'9")
Depth of apron:	2.50M (8'2")
Depth of stage (including apron):	8.40M (27'6")
Width of stage (including wings):	12.94M (42'5")
Width of stage right wings:	1.2M (3'11")

Stage left wings continue into the loading bay.

Any other dimensions required available on request to the Technical Manager.

Flys:

We have a bar upstage for use with back-cloths, 1 bar just upstage of the mid stage tabs, with another downstage of the mid tabs. All bars have a SWL 100KG.

Length:	9.15M (30')
Max flying height:	7.3M (23'11")

All bars are standard 48mm aluminium tube.

We also have extra black legs and borders available if required.

Lighting Rig:

Our bars contain a pre-rigged set of fixtures, which includes:

- 6x Clay Paky B-eye K10
- 6x Clay Paky B-eye K10 CC
- 8x Martin Mac Quantum
- 8x Source Four Profile

Please note this is pre-rigged in set positions in the rig. This can be removed as long as a minimum of 2 weeks' notice is given to the production manager.

Kyle Best
Production Manager

TIVOLI Theatre

19-27 West Borough, Wimborne, Dorset BH21 1LT

Tel:01202 849103 Fax:01202 849483

Friends of the Tivoli A company limited by guarantee registered in Wales No 3001139

Registered Office 19-23 West Borough, Wimborne, Dorset BH21 1LT

Registered Charity No. 1053930

Tivmanco Ltd., a wholly owned subsidiary of Friends of the Tivoli Theatre

Company registered in Wales no. 3237197

VAT reg No. 679 6756 55

Our floor package consists of 8 Chauvet R1 washes, which can be placed in any position on the stage. We also have 12x LED Battens which can be used.

Lighting Control is an Avolites Tiger Touch 2.

We have 6 circuits available on stage level from the cage in the scene dock. Please note that all of our channels are 2 kilowatt rated.

We have a stock of grelcos, TRS and DMX cables.

We also have 2x follow-spots available on request. Please be aware that these are subject to a recharge

Sound:

We have a permanently installed Nexo GEO S12 line array, made up of S1210 and S1230 boxes, and with two Nexo RS18 subs, and powered by a NXAMP4x4. We have four EM Acoustics EMS-51s installed on the front of the stage to act as front-fills. The system can be configured to have independent control of Left, Right, Sub and Fills.

We have two Digico SD9 consoles, both running Stealth Core 2 software upgrades. One of the consoles is fitted with a Waves card. We also have two Digico D-Racks (with expansion cards, giving a total I/O of 64/32).

We have eight Martin Audio LE1200 monitors set as passive, and four EM Acoustics EMS-61 loudspeakers (6.5" x 1").

For touring sound systems we have either 16A 32A or 63A single phase feeds, or even a 32A 3 phase feed.

If you require any further information on anything in this information pack please contact the Production Manager, on 01202 849 103 or kyle@tivoliwimborne.co.uk.

Kyle Best
Production Manager

TIVOLI Theatre

19-27 West Borough, Wimborne, Dorset BH21 1LT

Tel:01202 849103 Fax:01202 849483

Friends of the Tivoli A company limited by guarantee registered in Wales No 3001139

Registered Office 19-23 West Borough, Wimborne, Dorset BH21 1LT

Registered Charity No. 1053930

Tivmanco Ltd., a wholly owned subsidiary of Friends of the Tivoli Theatre

Company registered in Wales no. 3237197

VAT reg No. 679 6756 55

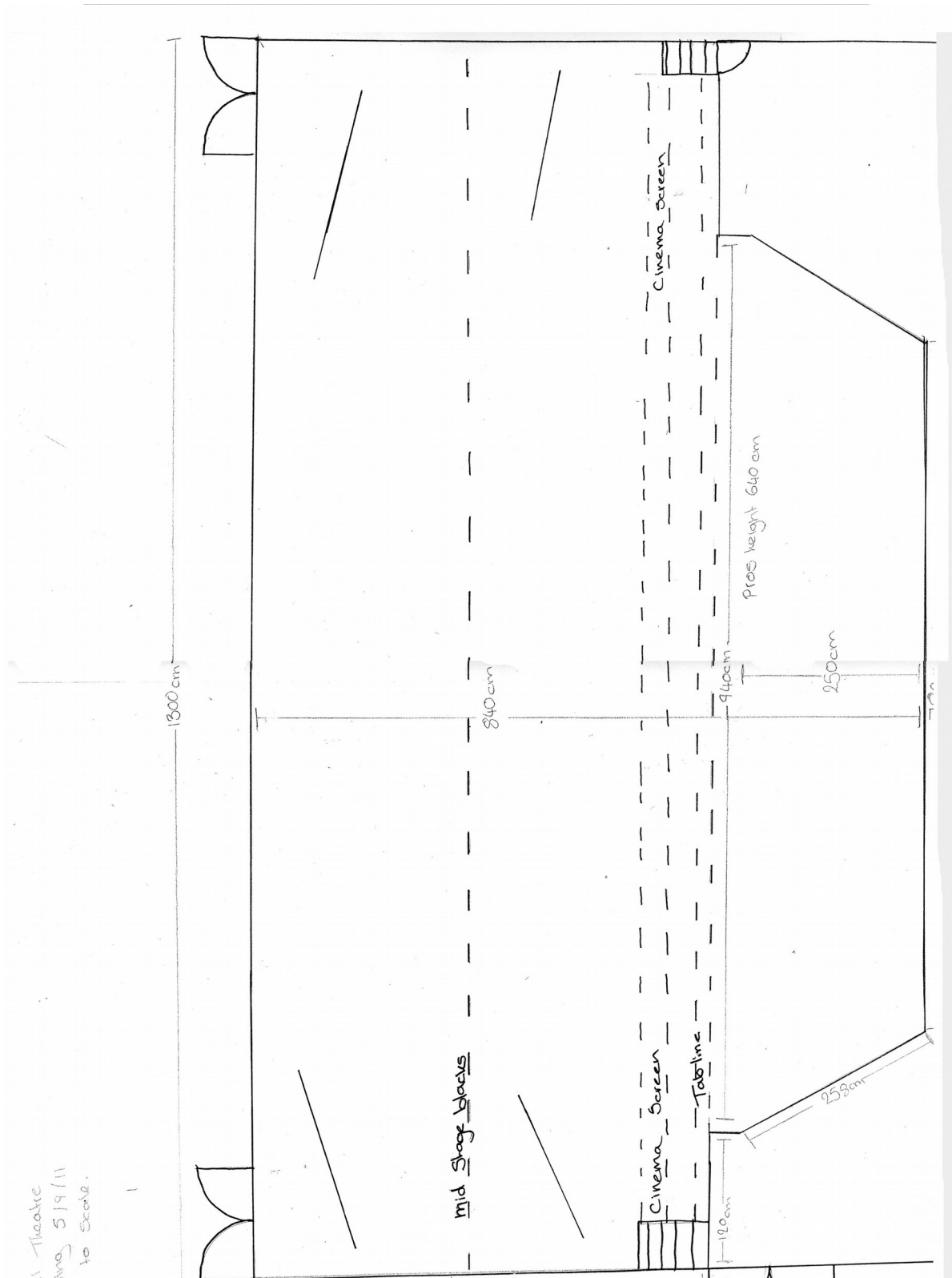

Kyle Best
Production Manager